

MAAX SUBMITTAL SPECIFICATIONS

Cocoon 6032

MODEL NUMBER 102722

DIMENSIONS: 60" x 32" x 21" Acrylic



STANDARD FEATURES

- Ergonomic headrest and built-in armrests
- Large bathing well
- Decorative molding
- Headrest channel allows water to drain easily
- Textured bottom
- Drop-in or alcove installation (apron available)

OPTIONS

- Acrylic apron
- One chromotherapy light
- Water heater assembly (factory installed)
- Microjet trim kit
- Hydrosens trim kit
- Metal trim kit for Air Push Control

UNIQUE FEATURES

- None

SYSTEMS

- Microjets
- Hydrosens
- Aerosens
- Combined Aerosens/Hydrosens
- BackmaxCombine with MAAX's complete shower door offering visit www.maax.com

DOOR SELECTION

CERTIFICATIONS

Maax products adhere to one or more of the following certifications:



Project :

Contractor :

MAAX Representative : Tel :

Date :

MAAX SUBMITTAL SPECIFICATIONS

Cocoon 6032

MODEL NUMBER 102722

TECHNICAL DRAWINGS

MICRO-JETS SYSTEM

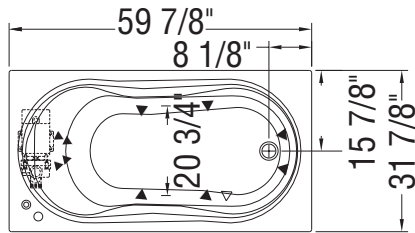

HYDROSENS, BACKMAX
 AND AIR SYSTEM

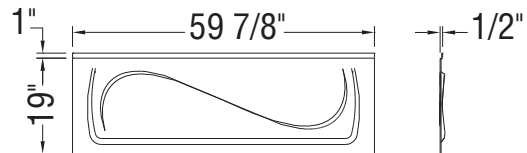
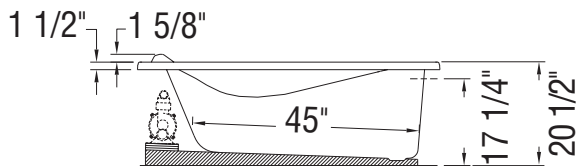
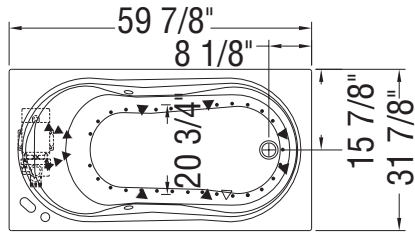

- (▲): Indicates whirlpool and backjets positioning
- (△): Indicates suction positioning
- (•): Indicates airjets positioning

All dimensions are approximate. Structure measurements must be verified against the unit to ensure proper fit.