

Pour les marches
 utiliser 2 (2X6) ou
 1 (2X10)
 Use 2 (2X6) or
 1 (2X10) for step

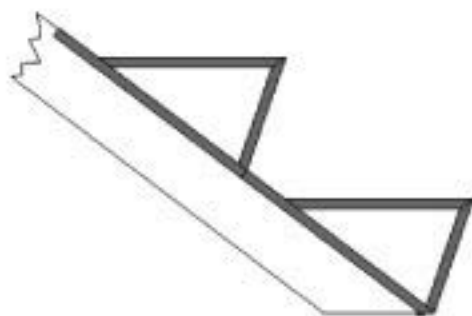

2X4
 (Jusqu'à 4 marches)
 (up to 4 steps)

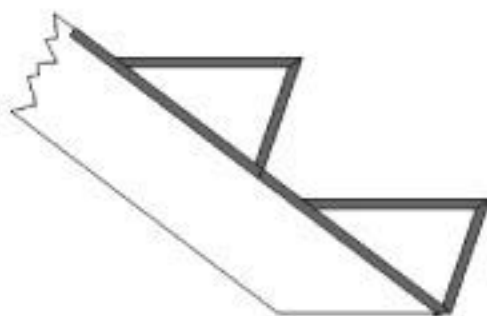

2X6
 (Jusqu'à 7 marches)
 (up to 7 steps)

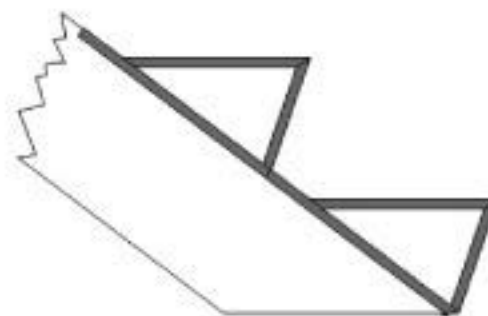

2X8
 (Jusqu'à 11 marches)
 (up to 11 steps)

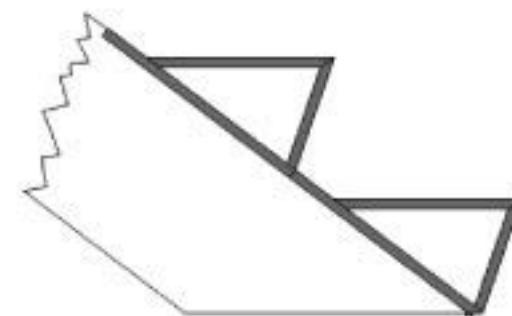

2X10
 (Jusqu'à 14 marches)
 (up to 14 steps)